

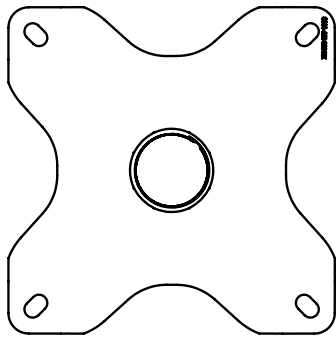

Offset Ceiling Adapter with 1.5" NPT Coupler Installation Instructions



The offset ceiling adapter with 1.5" NPT coupler (PP-4) is ideal for helping attach the 1.5" NPT pipe components of an A/V mount to the ceiling. Four (4) integrated cable channels make it simple to accomplish a clean installation on a solid ceiling surface. Use the included security screw to lock the 1.5" NPT pipe into position.

Parts List

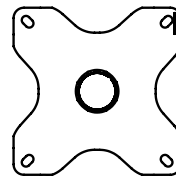

PP-4
(Qty 1)



M3 Security Allen
Wrench (Qty 1)



M6 x 6mm
Security Screw (Qty 1)

Step 2

Attach the 1.5" NPT pipe to the PP-4.

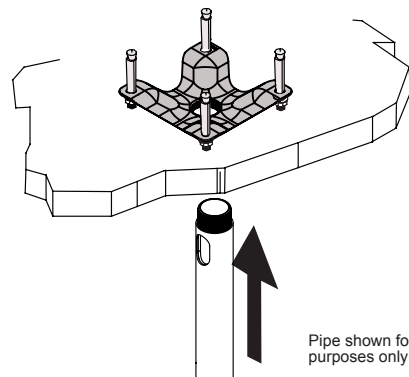

Pipe shown for illustration purposes only

Installing the PP-4



The ceiling should be capable of supporting at least five (5) times the weight of the product that will be used with this accessory. If the surface cannot support this weight, it must be reinforced. Proper installation procedure by qualified personnel as outlined in the installation instructions must be adhered to. Failure to do so could result in serious personal injury.



The PP-4 is designed to install on a solid ceiling surface.

Step 1

Use suitable, commercially available hardware to secure the PP-4 to the ceiling surface using the four corner mounting holes.

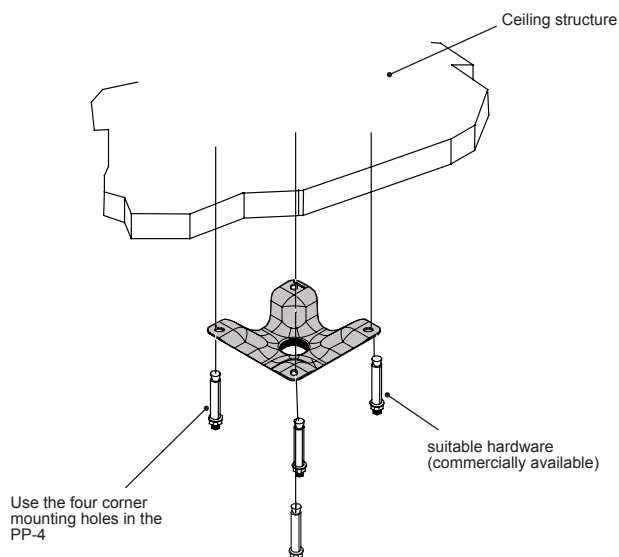

Step 3

Use the M3 security Allen wrench and one (1) M6 x 6mm security screw to secure the 1.5" NPT pipe to the PP-4.

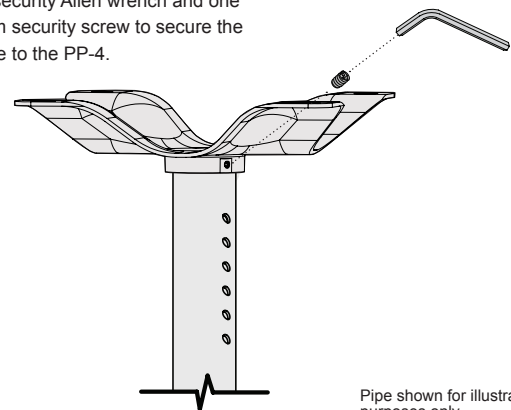

Pipe shown for illustration purposes only

Dimensions

